

Using Hauppauge Capture

After restarting your PC, you will see the **Hauppauge Capture icon** on your Windows desktop. Click this icon to start Hauppauge Capture.

For more information on Hauppauge Capture, how-to videos and the latest version of Hauppauge Capture, please look here: www.hauppauge.com/capture

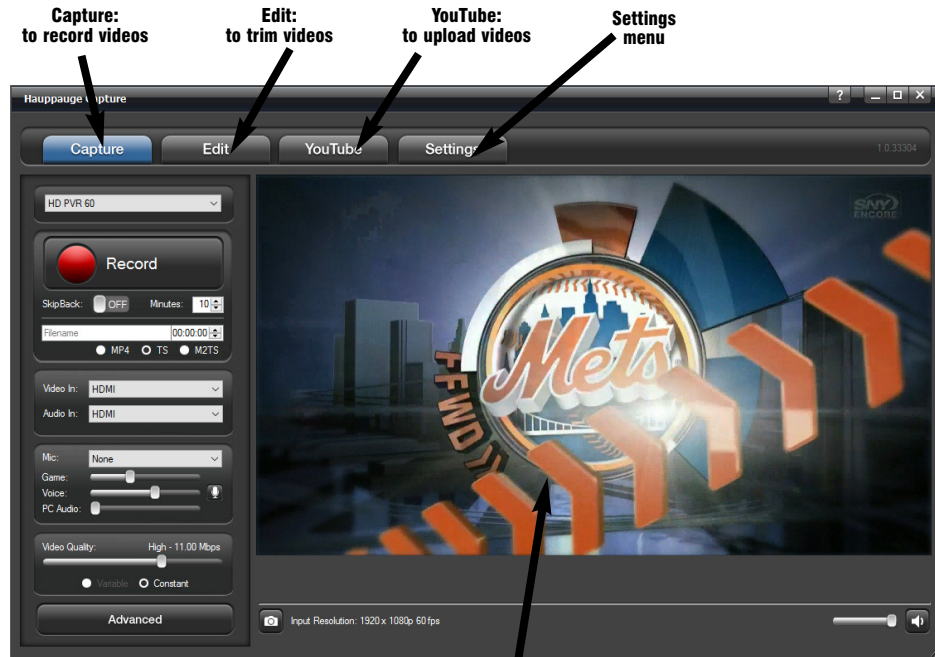

Capture: to record videos
Edit: to trim videos
YouTube: to upload videos
Settings menu:

Preview window: when you have chosen your video source, you should see your video here

Capture tab

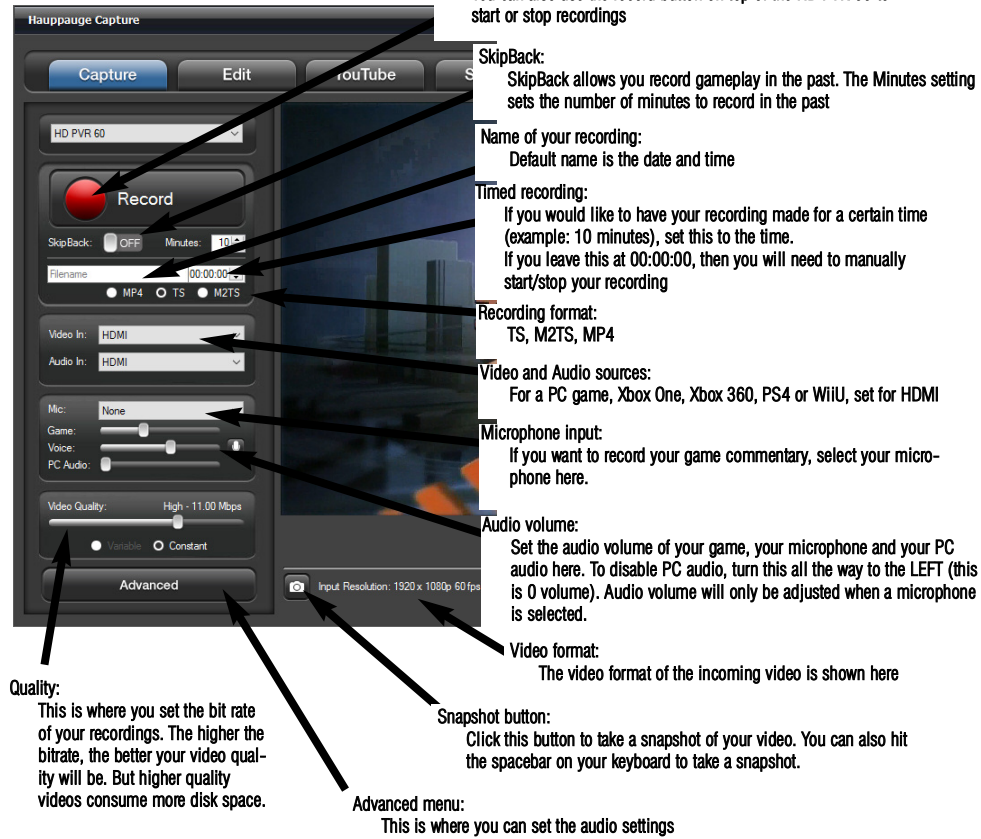

Start/Stop recording: You can also use the record button on top of the HD PVR 60 to start or stop recordings

SkipBack: SkipBack allows you record gameplay in the past. The Minutes setting sets the number of minutes to record in the past

Name of your recording: Default name is the date and time

Timed recording: If you would like to have your recording made for a certain time (example: 10 minutes), set this to the time. If you leave this at 00:00:00, then you will need to manually start/stop your recording

Recording format: TS, M2TS, MP4

Video and Audio sources: For a PC game, Xbox One, Xbox 360, PS4, or WiiU, set for HDMI

Microphone input: If you want to record your game commentary, select your microphone here.

Audio volume: Set the audio volume of your game, your microphone and your PC audio here. To disable PC audio, turn this all the way to the LEFT (this is 0 volume). Audio volume will only be adjusted when a microphone is selected.

Video format: The video format of the incoming video is shown here

Snapshot button: Click this button to take a snapshot of your video. You can also hit the spacebar on your keyboard to take a snapshot.

Advanced menu: This is where you can set the audio settings

Quality: This is where you set the bit rate of your recordings. The higher the bitrate, the better your video quality will be. But higher quality videos consume more disk space.

Edit tab



File selector: Your last recording will be at the top of the list. You can also choose any other recording.

Export to MP4: Some video editors need an MP4 file. When you are finished trimming your videos, click this button and your video will be converted to MP4 without any loss in video quality.

Start and pause your video: You can start or pause your videos with this button

Cut from the LEFT: When you click this button, you will delete all of the video to the LEFT of the video mark.

Video mark: This shows you the current position in your recording of the video you see in the preview window

Cut from the RIGHT: When you click this button, you will delete all of the video to the RIGHT of the video mark.

YouTube tab

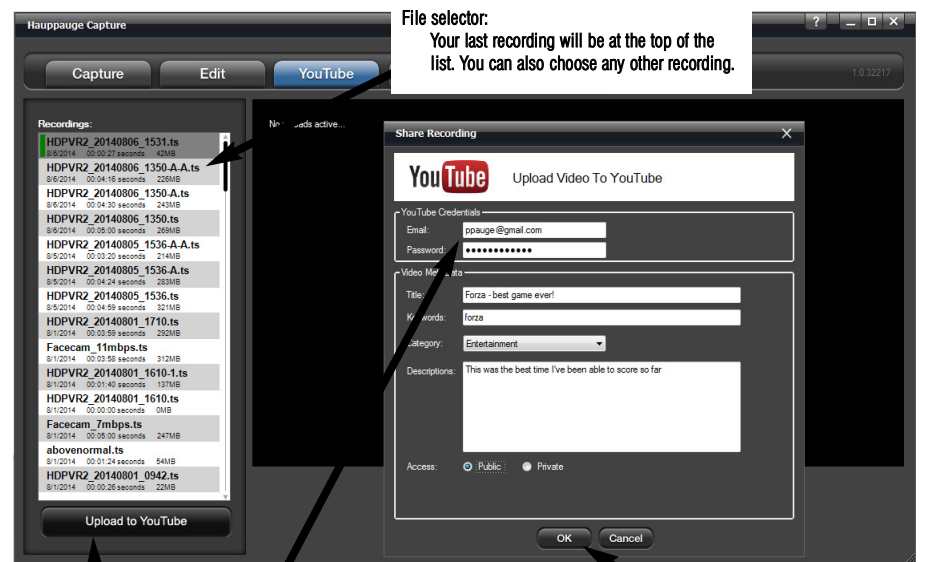

File selector: Your last recording will be at the top of the list. You can also choose any other recording.

Upload to YouTube: After you have trimmed your videos, click here to upload them to YouTube.

Enter your YouTube credentials: Enter your user name and password.

Note: if you have multiple YouTube accounts linked to one user name and password, you cannot use this function to upload to YouTube. You will need to manually upload using a web browser. Your videos can be found in the Videos folder on your PC.

Enter the Title, Keywords and Description: This is the minimum information required by YouTube to upload your videos. Then click OK.

StreamEez tab

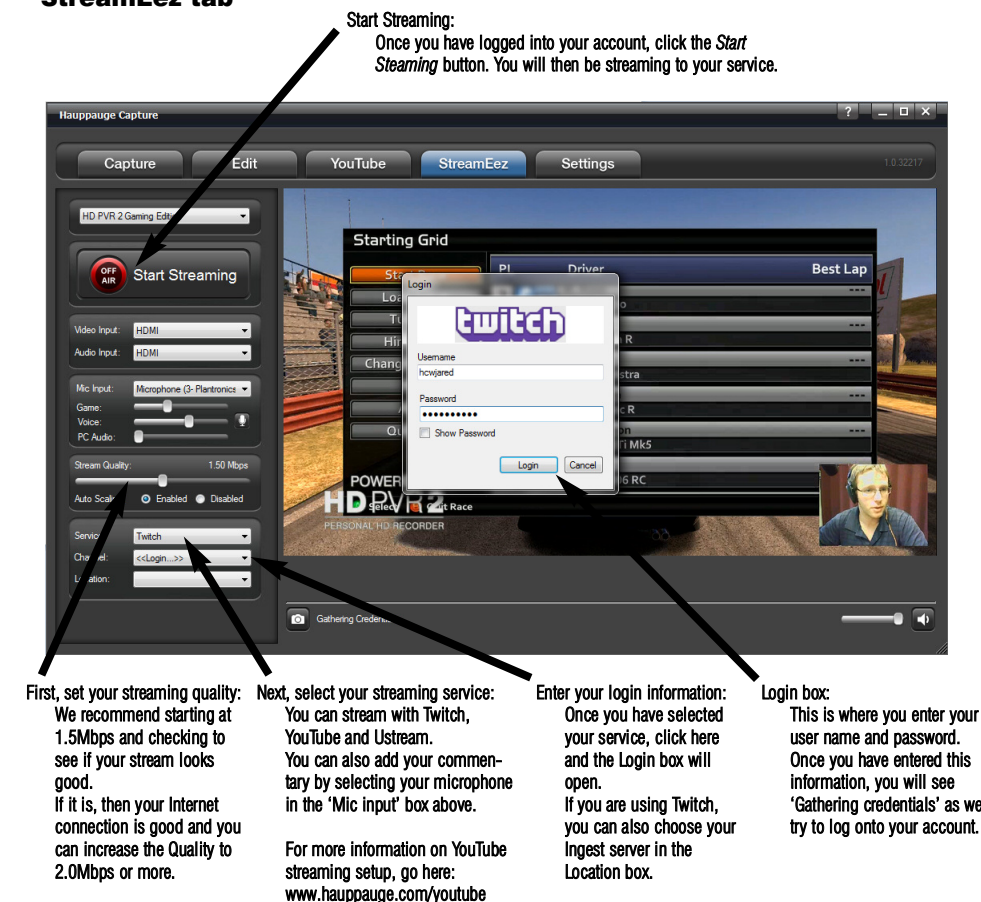

Start Streaming: Once you have logged into your account, click the Start Streaming button. You will then be streaming to your service.

First, set your streaming quality: We recommend starting at 1.5Mbps and checking to see if your stream looks good. If it is, then your Internet connection is good and you can increase the Quality to 2.0Mbps or more.

Next, select your streaming service: You can stream with Twitch, YouTube and Ustream. You can also add your commentary by selecting your microphone in the 'Mic input' box above.

For more information on YouTube streaming setup, go here: www.hauppauge.com/youtube

Enter your login information: Once you have selected your service, click here and the Login box will open.

Login box: This is where you enter your user name and password. Once you have entered this information, you will see 'Gathering credentials' as we try to log onto your account.

Settings tab

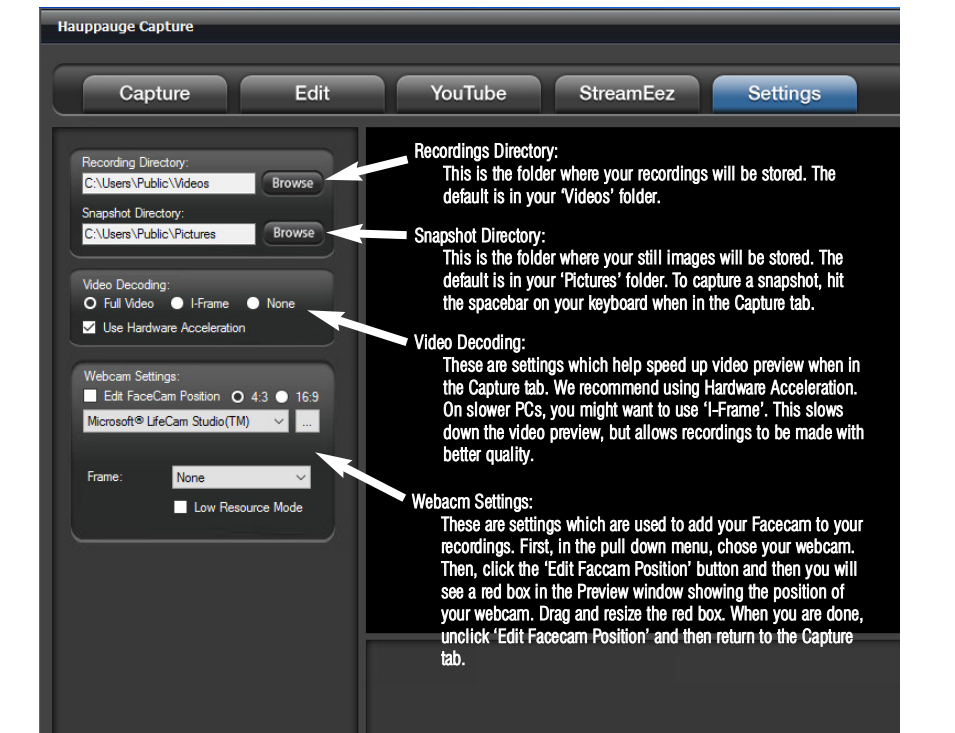

Recordings Directory: This is the folder where your recordings will be stored. The default is in your 'Videos' folder.

Snapshot Directory: This is the folder where your still images will be stored. The default is in your 'Pictures' folder. To capture a snapshot, hit the spacebar on your keyboard when in the Capture tab.

Video Decoding: These are settings which help speed up video preview when in the Capture tab. We recommend using Hardware Acceleration. On slower PCs, you might want to use 'I-Frame'. This slows down the video preview, but allows recordings to be made with better quality.

Webcam Settings: These are settings which are used to add your Facecam to your recordings. First, in the pull down menu, choose your webcam. Then, click the 'Edit Facecam Position' button and then you will see a red box in the Preview window showing the position of your webcam. Drag and resize the red box. When you are done, unclick 'Edit Facecam Position' and then return to the Capture tab.